

uDirect 2 Bluetooth pairing guide

Personal computer (PC)

Pairing and connecting uDirect 2 with a personal computer (PC)

You can use uDirect™ 2 to listen to audio on your PC if your PC supports Bluetooth®. You must first perform the Bluetooth pairing procedure between uDirect and your PC as described below.

To pair uDirect 2 and a personal computer (PC):

1. Charge and turn **ON** your PC and uDirect 2. Place them next to one another.
2. Ensure the Bluetooth connectivity is turned **ON**. Either activate the built-in Bluetooth functionality or connect the external Bluetooth adapter on your PC.
3. On the PC, go to **My Bluetooth Places** and select **Add Bluetooth Device**. Or, **Start > Control Panel**, and select **Bluetooth Device Wizard**.
4. To initiate the pairing process on uDirect 2, set uDirect 2 into pairing mode by pressing and holding the (+) and (<>) buttons for about two seconds until the Bluetooth LED indicator is blue and flashing quickly. uDirect 2 is now in pairing mode for two minutes or until the pairing is complete.
5. On the PC, navigate to **find and add a specific Bluetooth device**.
6. Under the list of found Bluetooth devices, choose **uDirect 2**.
7. When the PC prompts for a passcode or PIN, enter **0000** (four zeros).
8. Allow the devices to establish a trusted link.
9. If prompted on the PC to choose Bluetooth services, you may have several options available. Select **Stereo Headset** to stream audio in stereo.
10. After choosing which services to enable, finish the connection and exit the setup on the PC. The Bluetooth LED indicator flashes blue slowly indicating that the devices are successfully paired.

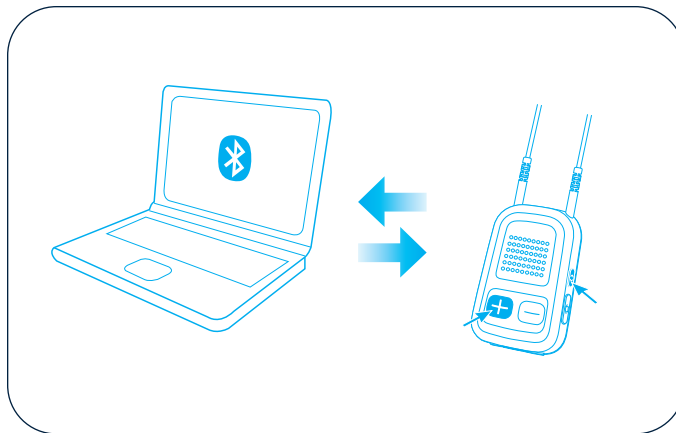

PC compatibility issues

Bluetooth functionality is implemented in different ways depending on the PC manufacturer. Some PCs with Bluetooth functionality are compatible only with certain types of devices. If a problem occurs with the connection between your PC and uDirect 2, or if you are uncertain of your PC's Bluetooth capabilities, consult your PC user guide or ask your PC dealer.