

# uDirect 2 Bluetooth pairing guide

## iPhone

### Pairing and connecting uDirect 2 with your iPhone

Charge and turn on both your iPhone® and uDirect™ 2. Place them next to one another.

#### Turning on iPhone® Bluetooth®

1. From the Home screen, select the **Settings** app.
2. Select **General**.
3. Select **Bluetooth** and turn Bluetooth **ON**. iPhone will start searching for nearby Bluetooth-enabled devices.

#### Setting uDirect 2 into pairing mode

To initiate the pairing process on uDirect 2, set uDirect 2 into pairing mode by pressing and holding the (+) and (<>) buttons for about two seconds until the Bluetooth LED indicator is blue and flashing quickly. uDirect 2 is now in pairing mode for two minutes or until the pairing is complete.

#### Searching for uDirect 2 and confirming pairing with passcode 0000 (four zeros)

Under the list of available devices, select **uDirect 2** and enter **0000** (four zeros) when asked for the passcode or passkey. Allow the devices to complete the pairing process. On the iPhone, uDirect 2 is shown as a paired device and on uDirect 2, the Bluetooth LED indicator flashes slowly, indicating that the devices are successfully paired.

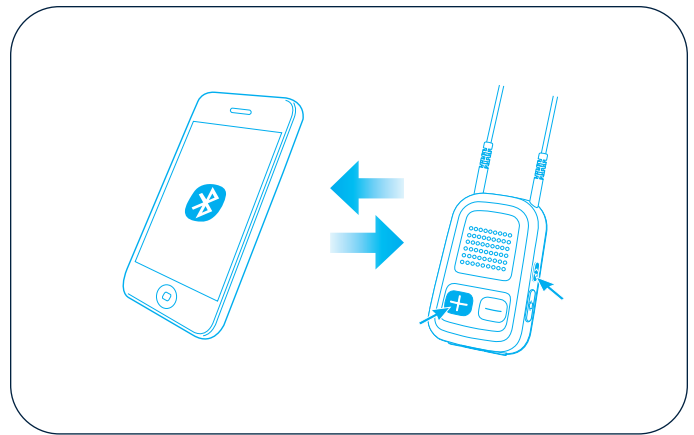

#### Connecting uDirect 2 with your iPhone

In addition to being paired, which is done only once, your uDirect 2 and iPhone need to be connected. This is done either automatically or via the iPhone's menu.

If prompted to allow automatic reconnection, do so. This way uDirect 2 and your iPhone will reconnect whenever within range.

#### iPhone compatibility issues

Unfortunately, iPhone models with Bluetooth functionality are compatible only with certain types of devices. If a problem occurs with the connection between your iPhone and uDirect 2, or if you are uncertain of your iPhone's Bluetooth capabilities, consult your iPhone user guide or ask your Apple® dealer.