

uDirect 2 Bluetooth pairing guide

BlackBerry (6 OS)

Pairing and connecting uDirect 2 with your BlackBerry

Charge and turn on both your BlackBerry® and uDirect™ 2. Place them next to one another.

Turning on BlackBerry Bluetooth® (6 OS)

1. On the home screen, click the connections area at the top of the screen, or click the **Manage Connections** icon.
2. To turn on Bluetooth technology, select the **Bluetooth** checkbox.

Setting uDirect 2 into pairing mode

To initiate the pairing process on uDirect 2, set uDirect 2 into pairing mode by pressing and holding the (+) and (<>) buttons for about two seconds until the Bluetooth LED indicator is blue and flashing quickly. uDirect 2 is now in pairing mode for two minutes or until the pairing is complete.

Searching for uDirect 2 and confirming pairing with passcode 0000 (four zeros)

1. On the Home screen, click the connections area at the top of the screen, or click the **Manage Connections** icon.
2. Click **Networks and Connections > Bluetooth Connections > Add New Device > Search**.
3. Select the Unitron uDirect 2.
4. Enter the Passkey: **0000** (four zeros) when asked for the passcode or passkey. Allow the devices to complete the pairing process. On the BlackBerry, uDirect 2 is shown as a paired device. Under **Paired devices**, select **uDirect 2**.
5. On uDirect 2, the Bluetooth LED indicator flashes slowly, indicating that the devices are successfully paired.

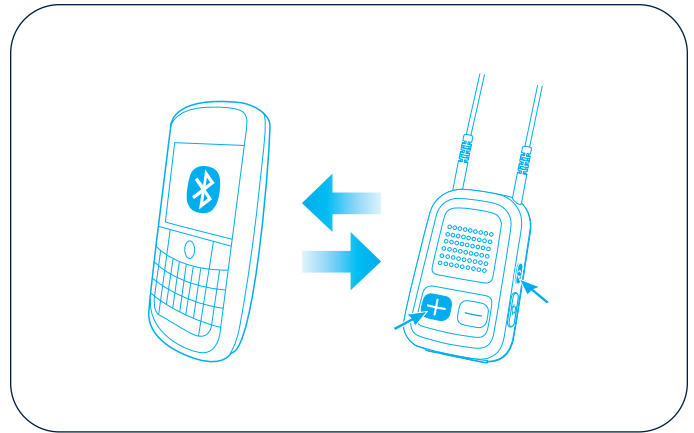

Connecting uDirect 2 with your BlackBerry

In addition to being paired, which is done only once, your uDirect 2 and BlackBerry need to be **connected**.

1. On the Home screen, click the connections area at the top of the screen, or click the **Manage Connections** icon.
2. Click **Networks and Connections > Bluetooth Connections**.
3. Highlight Unitron uDirect 2 and press the Connect key.

BlackBerry compatibility issues

Unfortunately, some BlackBerry models with Bluetooth functionality are compatible only with certain types of devices. If a problem occurs with the connection between your BlackBerry and uDirect 2, or if you are uncertain of your BlackBerry's Bluetooth capabilities, consult your BlackBerry user guide or ask your BlackBerry dealer.

uDirect 2 Bluetooth pairing guide

BlackBerry (device software v 5.0)

Pairing and connecting uDirect 2 with your BlackBerry

Charge and turn on both your BlackBerry® and uDirect™ 2. Place them next to one another.

Turning on BlackBerry Bluetooth®

1. Press the **Menu** key.
2. Scroll to **Options** (on some phones **Settings**), and push the selection wheel (key) in to select it.
3. Select **Bluetooth** and **Enable Bluetooth**.

Setting uDirect 2 into pairing mode

To initiate the pairing process on uDirect 2, set uDirect 2 into pairing mode by pressing and holding the (+) and (<>) buttons for about two seconds until the Bluetooth LED indicator is blue and flashing quickly. uDirect 2 is now in pairing mode for two minutes or until the pairing is complete.

Searching for uDirect 2 and confirming pairing with passcode 0000 (four zeros)

1. On your BlackBerry, select **Add new device**, and **search**. The BlackBerry starts searching for Bluetooth enabled devices.
2. Under the list of available devices, select uDirect 2.
3. Enter the Passkey: **0000** (four zeros) when asked for the passcode or passkey. Allow the devices to complete the pairing process. On the BlackBerry, uDirect 2 is shown as a paired device. Under **Paired devices**, select **uDirect 2**.
4. On uDirect 2, the Bluetooth LED indicator flashes slowly, indicating that the devices are successfully paired.

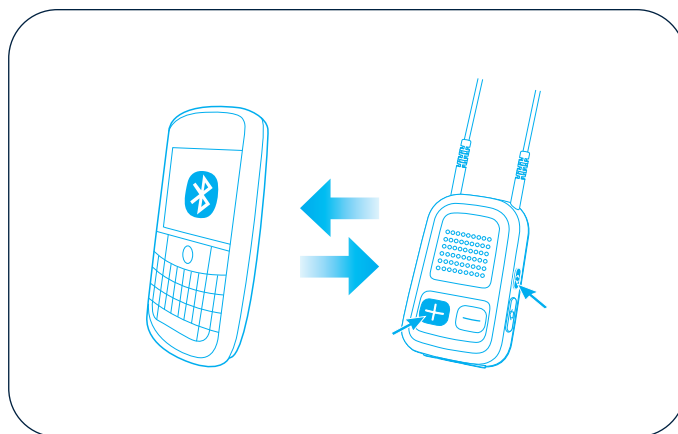

Connecting uDirect 2 with your BlackBerry

In addition to being paired, which is done only once, your uDirect 2 and BlackBerry need to be **connected**.

1. Under the Bluetooth menu on the BlackBerry, select **Connect**.
2. To allow uDirect 2 to connect to the BlackBerry again in the future without confirmation, press the selection wheel in, select **Device Properties** and press the selection wheel again.
3. Select **Ask** or **Trusted** and then **Yes**. uDirect 2 is now set as a trusted device.
4. Press the **Back button** (the button to the right of the selection wheel), and select **Save**.

BlackBerry compatibility issues

Unfortunately, some BlackBerry models with Bluetooth functionality are compatible only with certain types of devices. If a problem occurs with the connection between your BlackBerry and uDirect 2, or if you are uncertain of your BlackBerry's Bluetooth capabilities, consult your BlackBerry user guide or ask your BlackBerry dealer.