

iCube II

Setup instructions

iCube II is compatible with all Era,[™] North and Tempus platform wireless hearing instruments and can be used for regular fittings, as well as Flex:trial.[™]

Here are the steps to configure the iCube II in
Unitron TrueFit™ software:

Step 1

Enable iCube II for fitting

Go to [Options > Preferences > Fitting Device > iCube](#) and check the box [Enable iCube II for fitting](#). Select the method of connecting to the iCube II.

Preferences

☐ Enable iCube for fitting

☒ Enable iCube II for fitting

Check Connection

iCube / iCube II connected via USB

Update...@Factory Reset...

iCube II connected via USB adapter

Pairing Assistant

Not checked

iCube / iCube II via Bluetooth

Add iCube...

Serial number	Standard
---------------	----------

Close

Step 2

Pairing

The iCube II can be paired in the software in [three different ways](#):

a. [Using a wired connection:](#)

Go to [iCube II connected via USB](#) and follow the steps (same steps as with previous iCube).

b. [Using the Bluetooth adapter that comes with the new iCube II:](#)

The adapter has to be connected to the USB port of the computer.

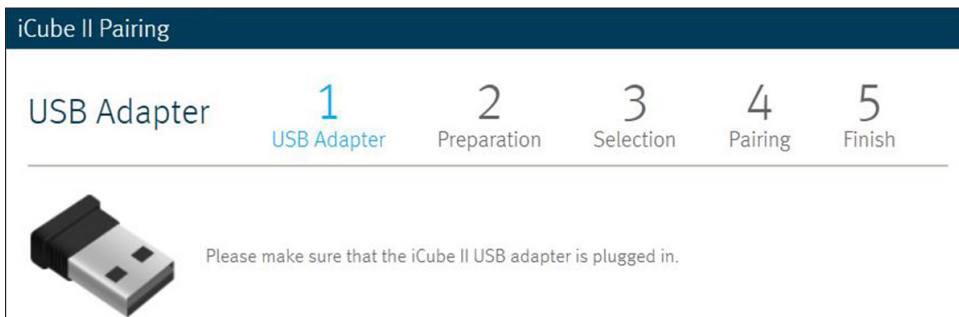

Verify that iCube II is turned on, press and hold the pairing button (↵) on the side until the three LED lights flash.

Then, click on the [Pairing Assistant](#) button and follow the instructions on the screen.

c. [Using iCube II via Bluetooth:](#)

Press and hold the pairing button (↵) on the side until the three LED lights flash to set the iCube II on pairing and follow the 4 steps on the screen.

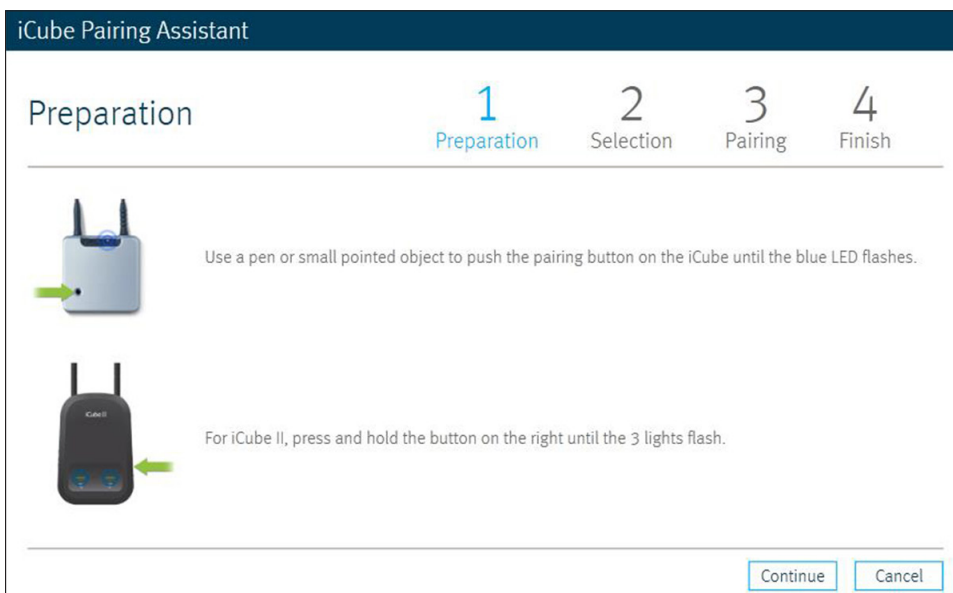

Step 3

Check the connection

Click on the [Check Connection](#) button. A green check mark will appear next to the iCube II.

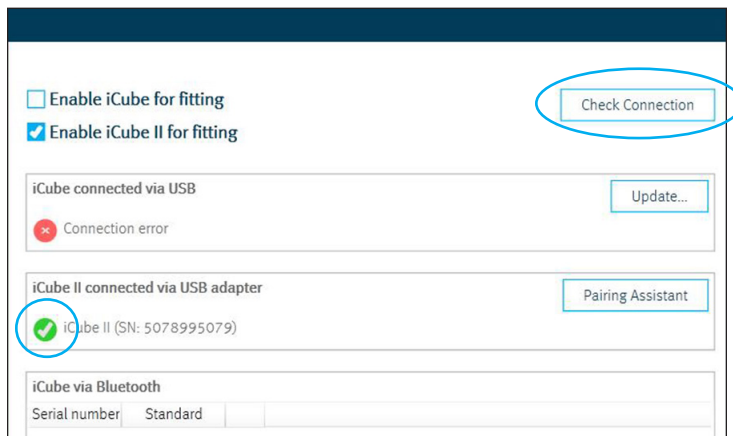

Step 4

End setup

The final step is to go to [Instruments > Selection](#) and select the iCube II as your programming interface.

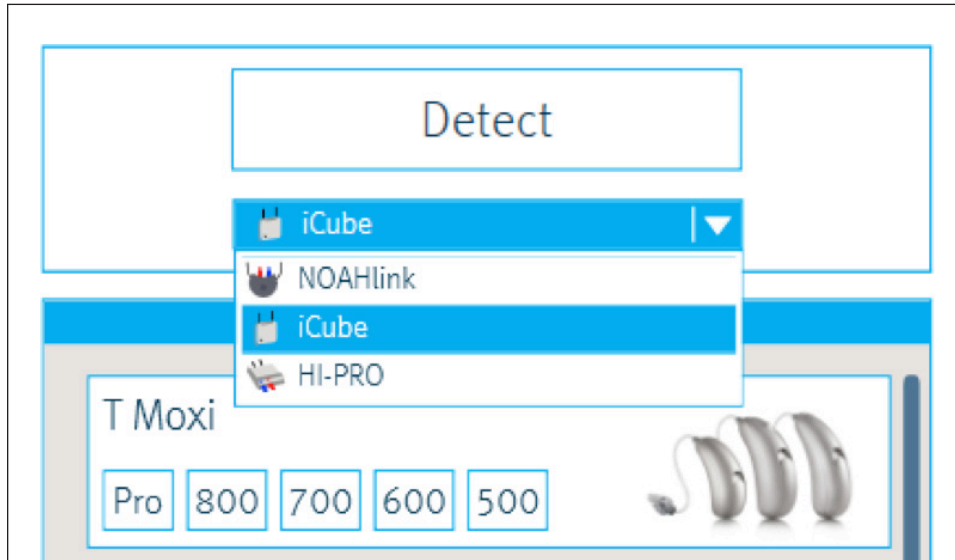

Previous wireless products, like Passport™ and Latitude™ will require the original iCube I for wireless programming, or a wired connection via HiPro or NoahLink.